

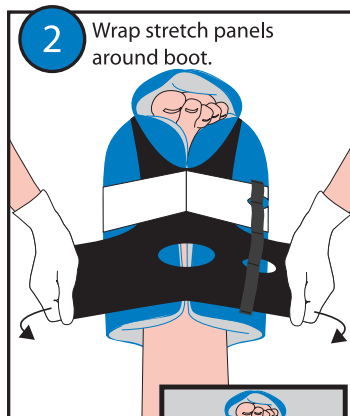

Using Prevalon™ Pressure-Relieving Heel Protector with Stabilizer Wedge

A Applying Prevalon Heel Protector

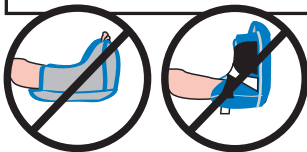
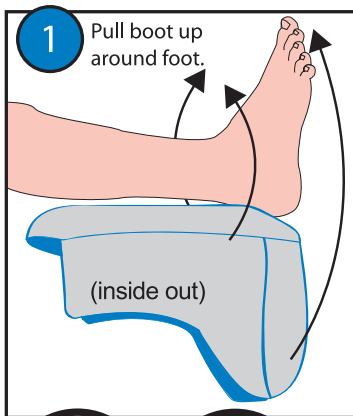

Deep vein thrombosis (DVT) compression device compatible. Make sure tubing is not kinked or compressed against your patient's skin.

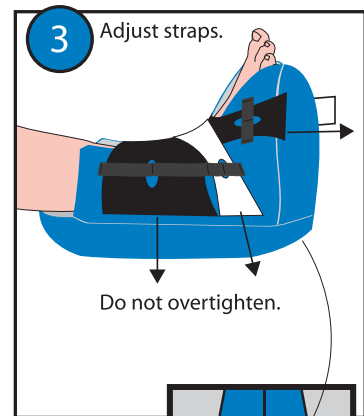

Make sure heel is floated.

B Attaching Prevalon Stabilizer Wedge

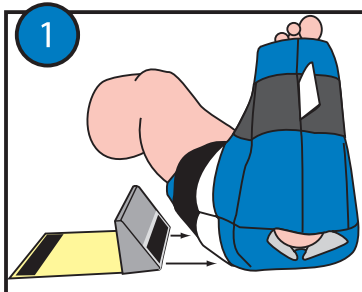

To attach Prevalon Stabilizer Wedge, place patient's foot in upright position. Slide foam wedge across mattress onto the outside of Heel Protector (lateral side of leg).

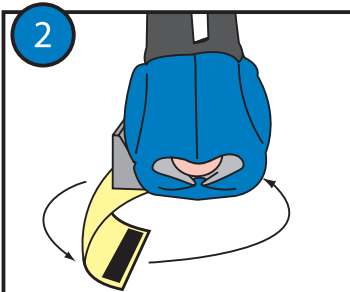

Lift leg. Slide clear panel under Heel Protector and attach to inside (medial side of leg).

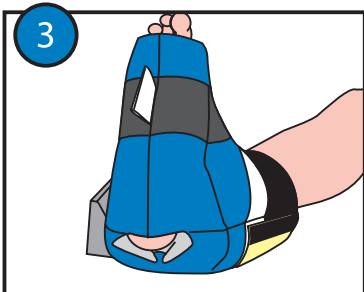

Make sure Prevalon Stabilizer Wedge is secured on both sides of Heel Protector and foot is in desired position. Readjust if necessary.

Periodically remove Prevalon™ Pressure-Relieving Heel Protector to assess skin according to protocol. Prevalon™ Stabilizer Wedge should be removed before repositioning patient on his side. Reapply when patient is in the supine position.

CAUTION: For use on patient while in bed. **DO NOT** allow patient to stand or walk while wearing.

Cleaning Instructions: Prevalon can be wiped clean with a damp cloth during use.

